

Product Datasheet

SBQ1005

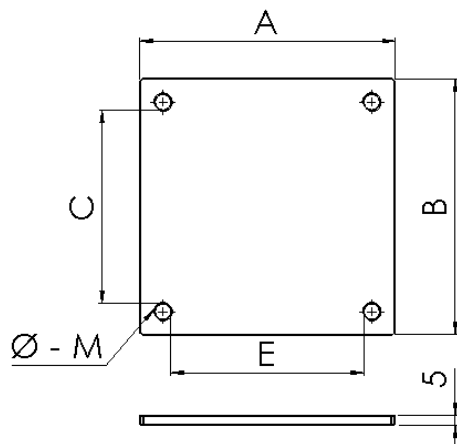

Main

Family	Accessories for busbars
Code	SBQ1005
Reference	SBQ 40x40
Number per package	4
E (mm)	42
C (mm)	42
A (mm)	63
B (mm)	63
Ø - M (mm)	6.5 - M6
Torque (Nm)	10

Disclaimer: This documentation is not intended as a substitute for and is not to be used for determining suitability or reliability of these products for specific user applications

Technical Features

Material: Galvanized steel

Max. tightening thickness: 20 mm (with 8.8 screws of length 30 mm supplied)

Compliant with: EN 60998-1

Plates thickness: 5 mm

Advantages

Connection without drilling and bolting.

Easy and quick use even on already mounted bar system.



Please contact Teknomega for non-specified tolerances.